

Attachment B

Map of Improvements

Site improvements subject to the Conservation Regulations that the Planning Commission acted on, because they are located within stream setbacks and occurred after adoption of the Conservation Regulations (1991):

- A.** An approximate 2,200 sq. ft. Ag Storage Barn and associated water tank that replaced an approximate 320 sq. ft. Barn;
- B.** An approximate 800 sq. ft. concrete pad located off the east side of the winery building;
- C.** An approximate 150 square foot ground floor/story addition and second floor/story deck to the Main Dwelling (a.k.a. farmhouse/office building) constructed/completed in 2011 under Building Permit #B08-00074;
- D.** An approximate 100 sq. ft. freestanding restroom constructed/completed in 2012 under Building Permit #B08-01030;
- E.** Approximately 1,210 lineal feet of low decorative rock walls;
- F.** Two pedestrian bridges.

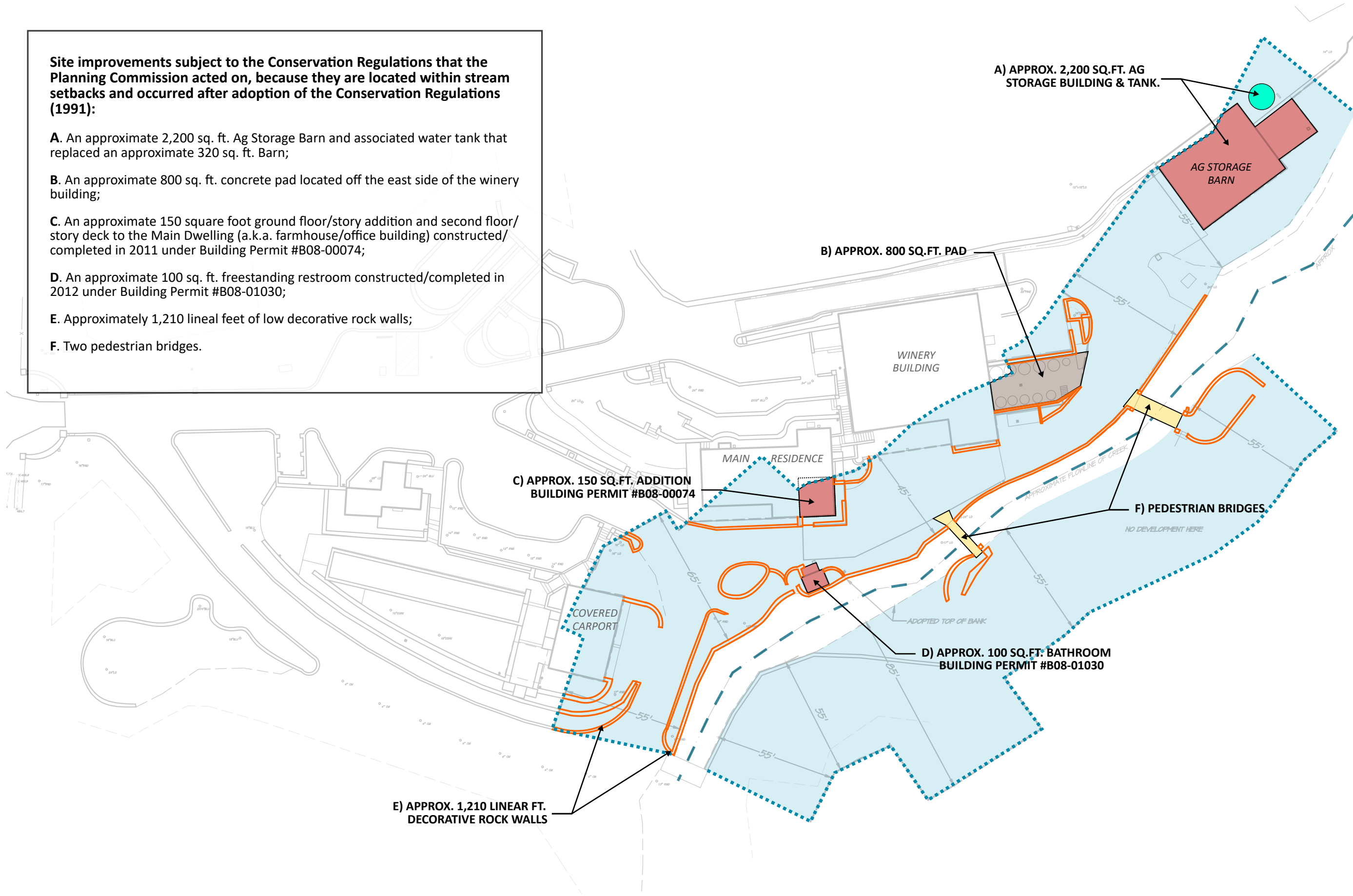

SITE IMPROVEMENTS - Bremer Use Permit Exception (PC approved)