

## LEGAL DESCRIPTION

THE FOLLOWING PROPERTY IS LOCATED IN THE COUNTY OF NAPA, STATE OF CALIFORNIA, AND IS MORE PARTICULARLY DESCRIBED AS FOLLOWS:

Commencing at the southwest corner of Parcel One, as shown on Map № 3628, recorded May 18, 1983 in Book 13 of Parcel Maps at page 72, Napa County Records, said point being distant North  $89^{\circ}15'55''$  West 5850 feet, more or less, from the intersection of the centerline of State Route № 29 and Green Island Road; thence North  $89^{\circ}15'55''$  West 550.62 feet to the northwest corner of parcel 1 as shown on Map № 3974, recorded December 1, 1986 in Book 15 of Parcel Maps at page 20, said Napa County Records; thence North  $0^{\circ}44'05''$  East 591.13 feet, more or less, to the southern line of Green Island Road; thence along said southern line South  $89^{\circ}23'55''$  East 549.24 feet to the northwest corner of said Parcel One, Map № 3628; thence along the west line of said Parcel One South  $0^{\circ}36'05''$  West 592.41 feet to the point of commencement.

Containing 7.47 more or less acres of land.

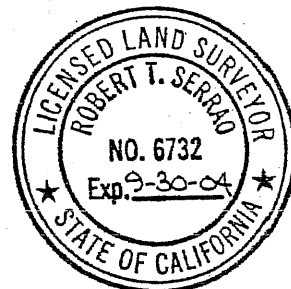

A handwritten signature in cursive script, appearing to read "Robert T. Serrao", written in black ink.

# MAP DELINEATING THE BOUNDARY OF "GREEN ISLAND ROAD ANNEXATION" AMERICAN CANYON FIRE PROTECTION DISTRICT AMERICAN CANYON, CALIFORNIA

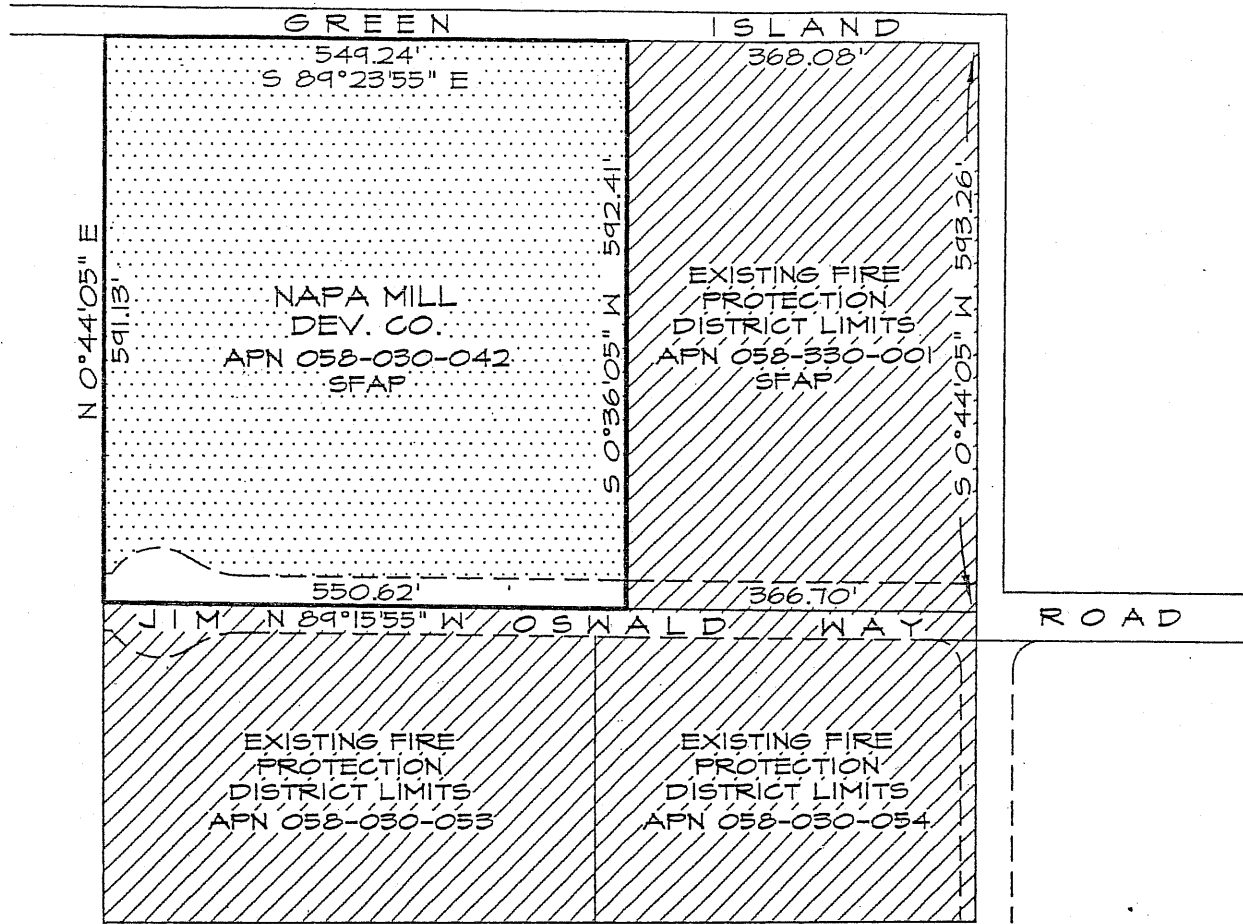

AREA: ±7.47 ACRES

 AREA TO BE ANNEXED TO AMERICAN CANYON FIRE PROTECTION DISTRICT

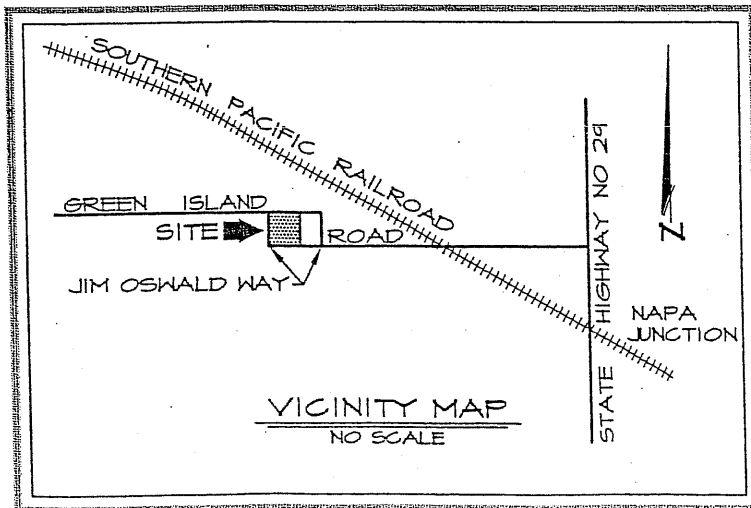
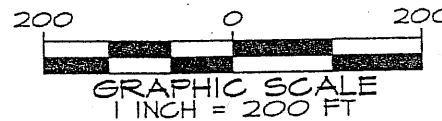
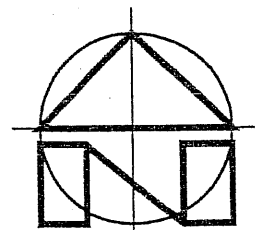

~PREPARED BY~  
**MICHAEL W. BROOKS & ASSOCIATES, INC.**  
*Professional Land Surveyors*  
Suite D3 Vintage 1870 Yountville, CA 94599 (707) 944-8743  
OCTOBER 2003 3544ANNEX.D