

NAPA COUNTY LAND USE PLAN 2008 - 2030

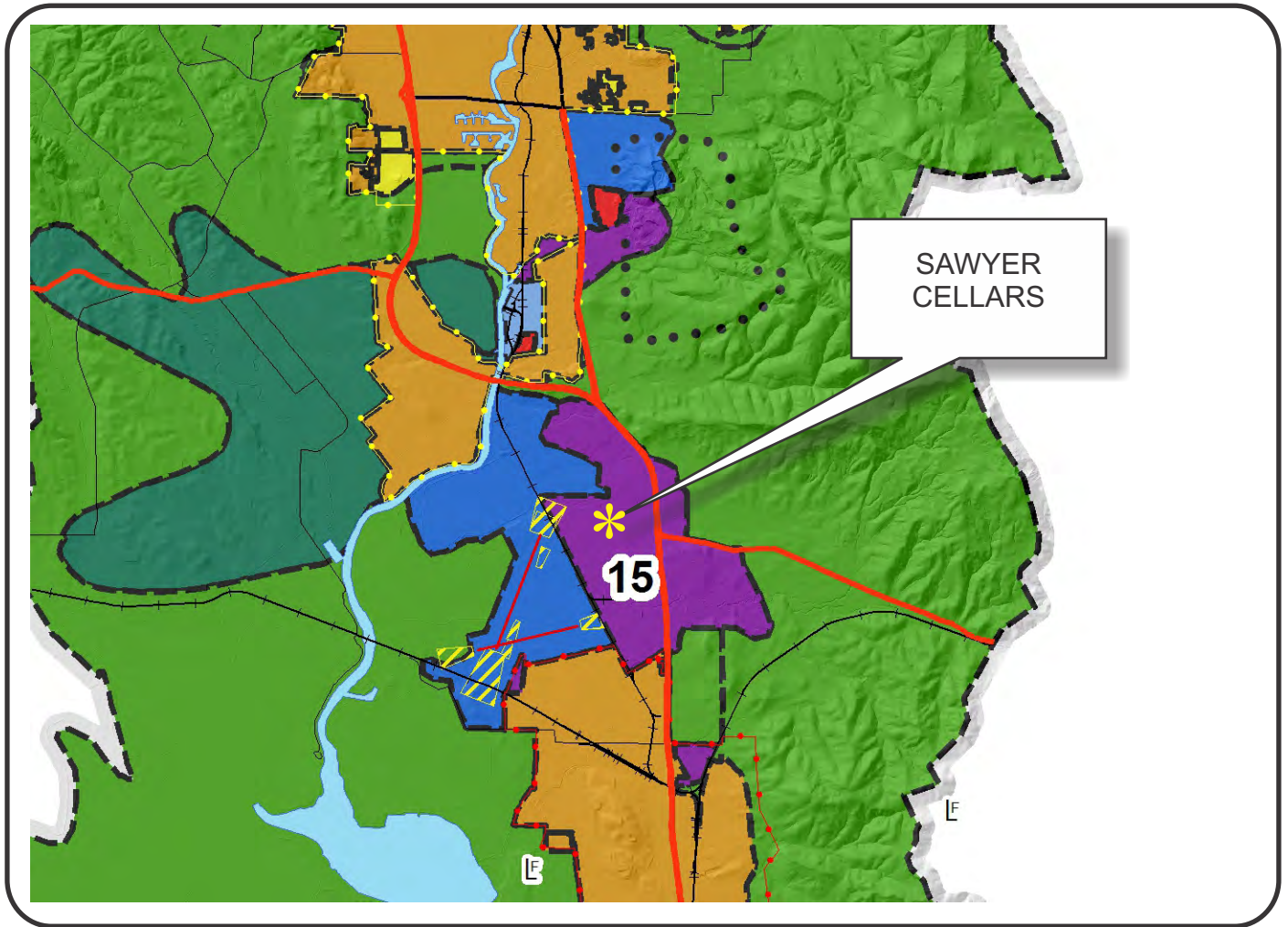

LEGEND



URBANIZED OR NON-AGRICULTURAL

- Study Area
- Cities
- Urban Residential*
- Rural Residential*
- Industrial
- Public-Institutional
- Napa Pipe Mixed Use

OPEN SPACE

- Agriculture, Watershed & Open Space
- Agricultural Resource

TRANSPORTATION

- Mineral Resource
- Limited Access Highway
- Major Road
- American Canyon ULL
- City of Napa RUL
- Landfill - General Plan
- Secondary Road
- Airport
- Railroad
- Airport Clear Zone

* See Action Item AG/LU-114.1 regarding agriculturally zoned areas within these land use designations

APN
057-330-005
04-28-2015
2C UP

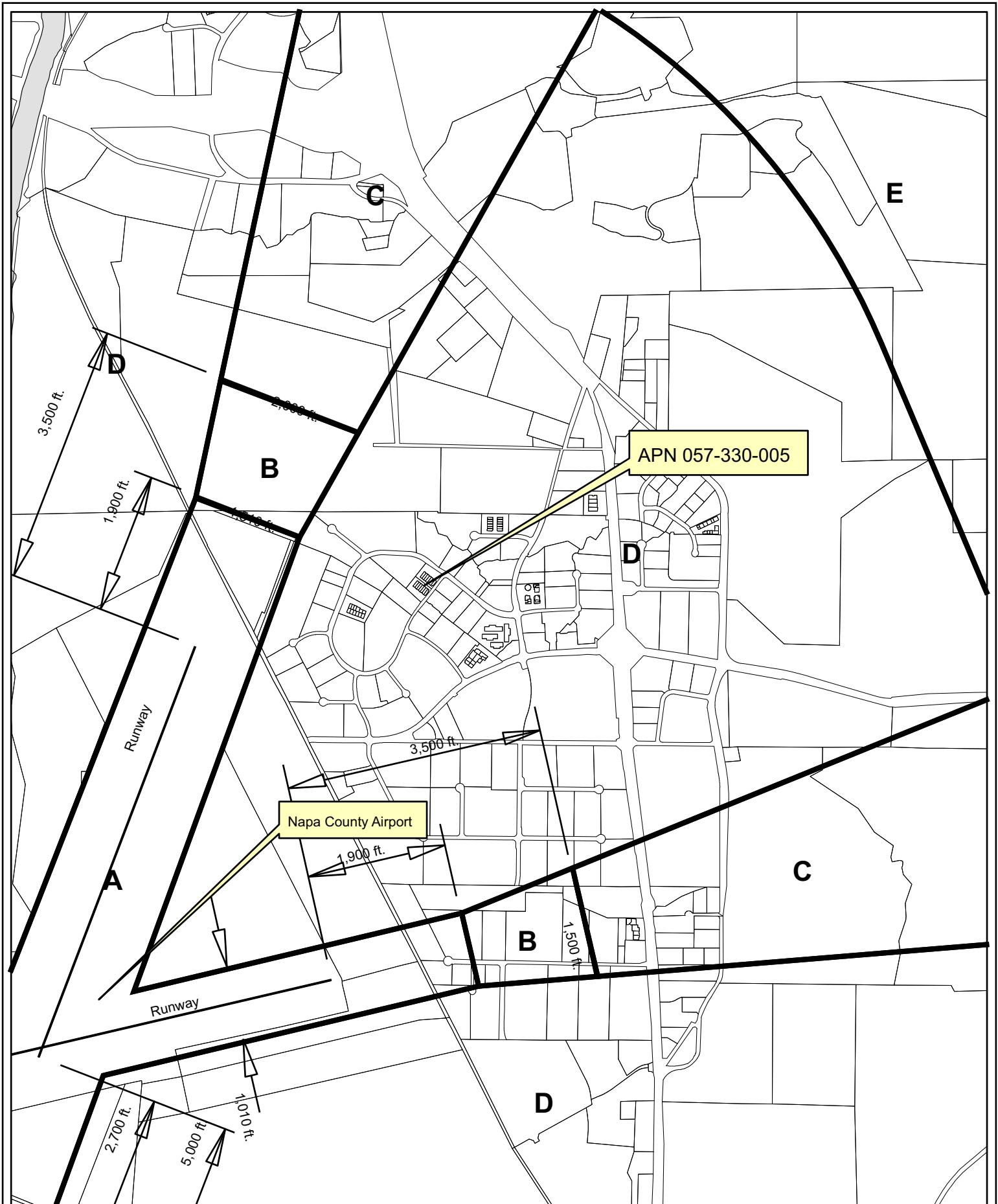

Horizontal Datum: NAD 83,
CA State Plane Coordinates,
Zone II, feet



Disclaimer: This map was prepared for informational purposes only. No liability is assumed for the accuracy of the data delineated herein.

Compatibility Plan

Napa County Airport



0 430 860 1,720'

Napa County P.B.E.S. - 10/2014

SAWYER CELLARS

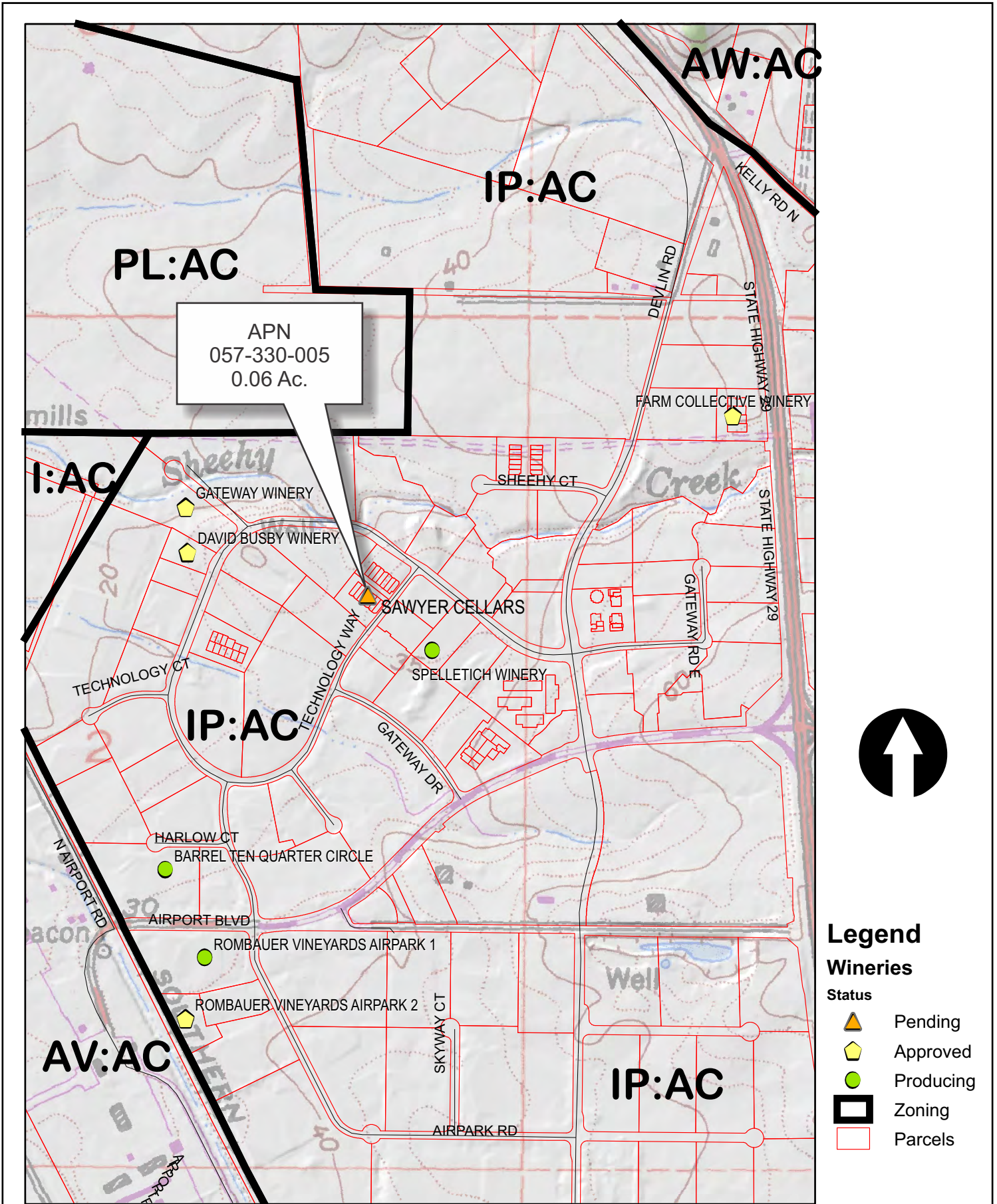



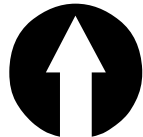

APN
057-330-005
0.06 Ac.



Legend

Wineries

Status

-  Pending
-  Approved
-  Producing
-  Zoning
-  Parcels

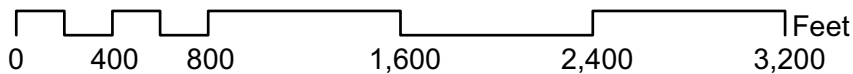

SAWYER CELLARS



APN
057-330-005
0.06 Ac.

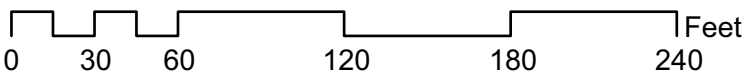

Existing Conditions
photo date: 2014

04-28-2015

2C

UP

04



Napa County Conservation
Development and Planning Department

SawyerCellars_P14-00353_up1.cdr

SAWYER CELLARS

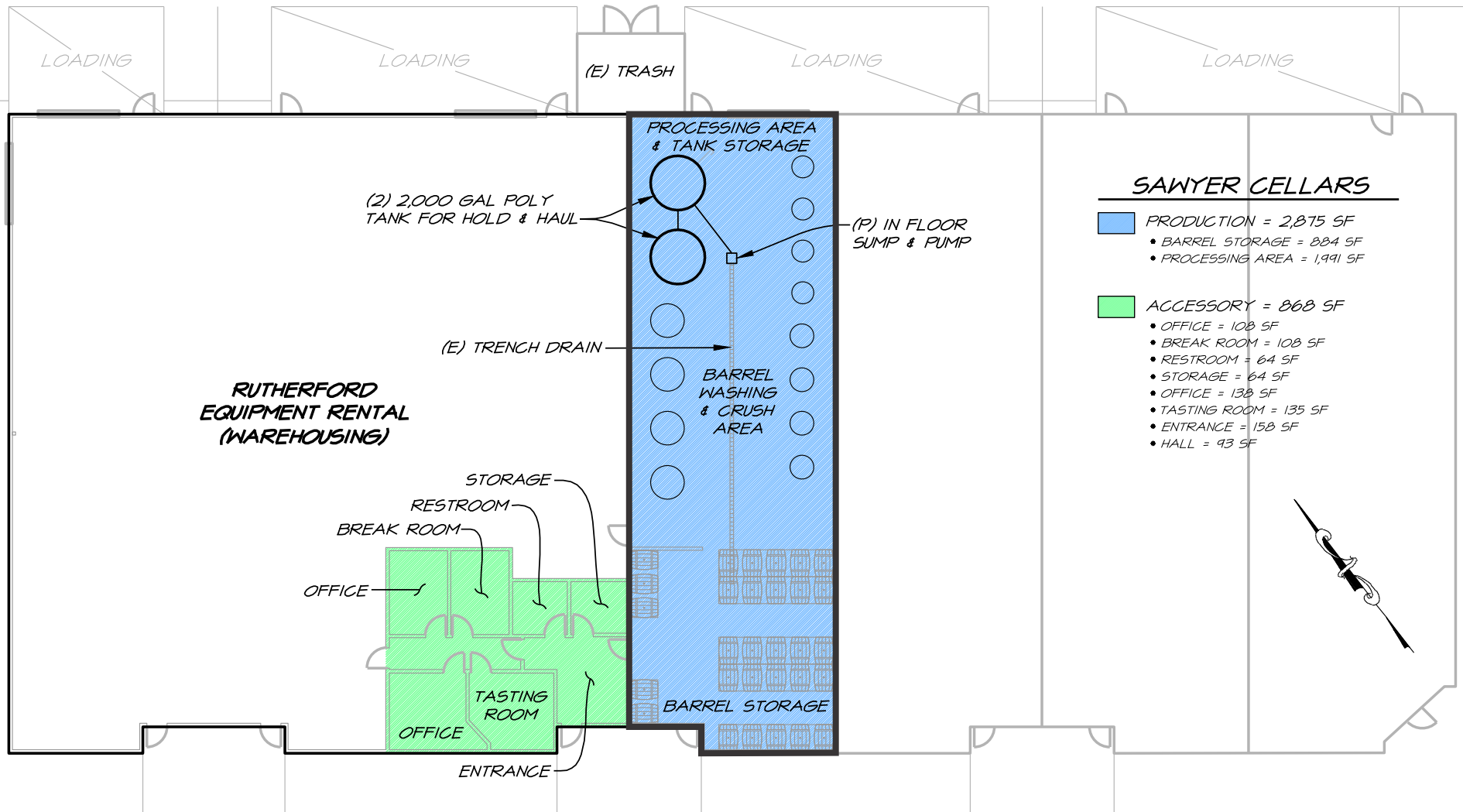

RSA⁺
 1515 FOURTH ST
 NAPA, CALIF. 9
 OFFICE | 707 | 252.3301
 + www.RSAcivil.com +

RSA⁺ | CONSULTING CIVIL ENGINEERS + SURVEYORS + est. 1980

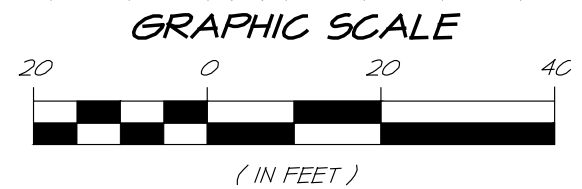

SAWYER CELLARS

SAWYER CELLARS HOLD & HAUL PLAN

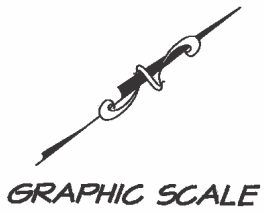
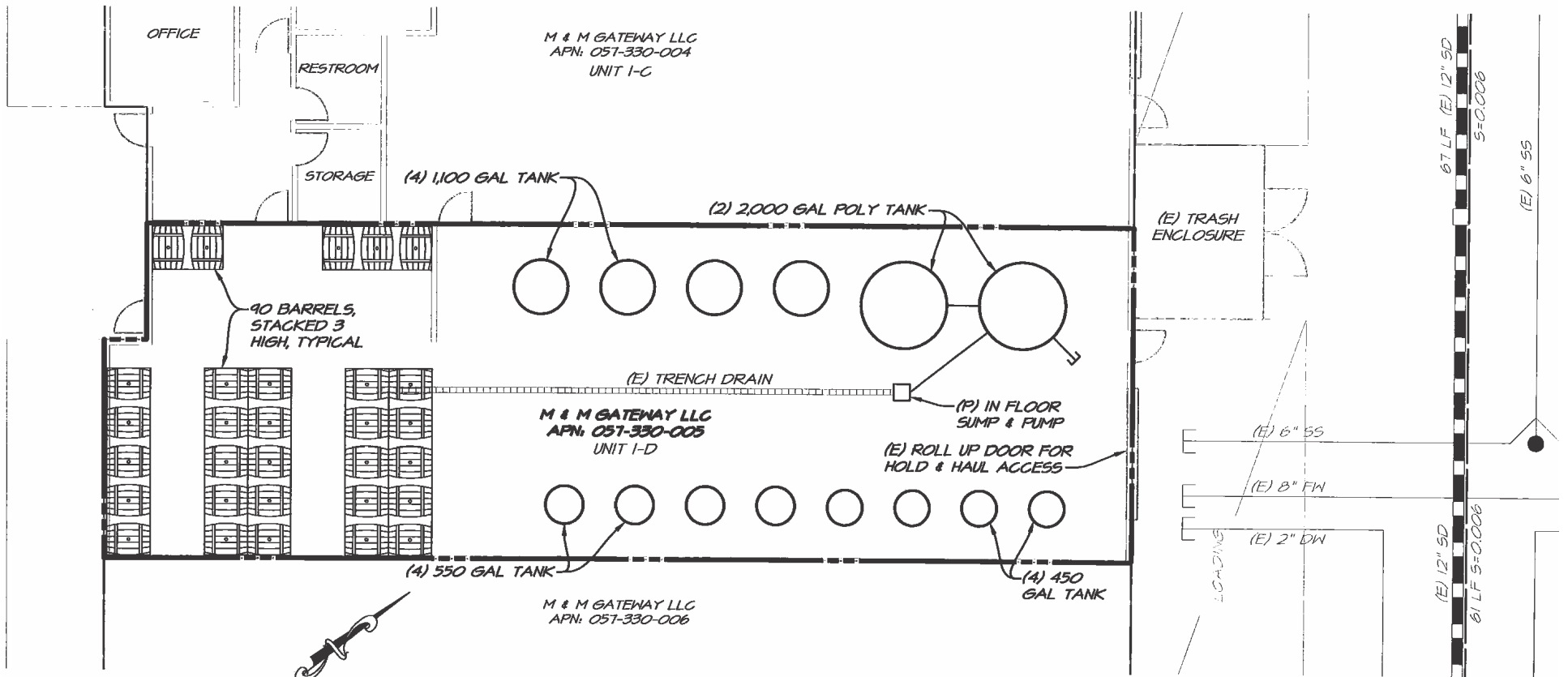

RSA+
1515 FOURTH STREET
NAPA, CALIF. 94559
OFFICE | 707 | 252.3301
+ www.RSAcivil.com +

RSA* | CONSULTING CIVIL ENGINEERS + SURVEYORS + EST. 1980

SAWYER CELLARS

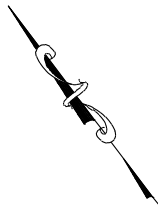
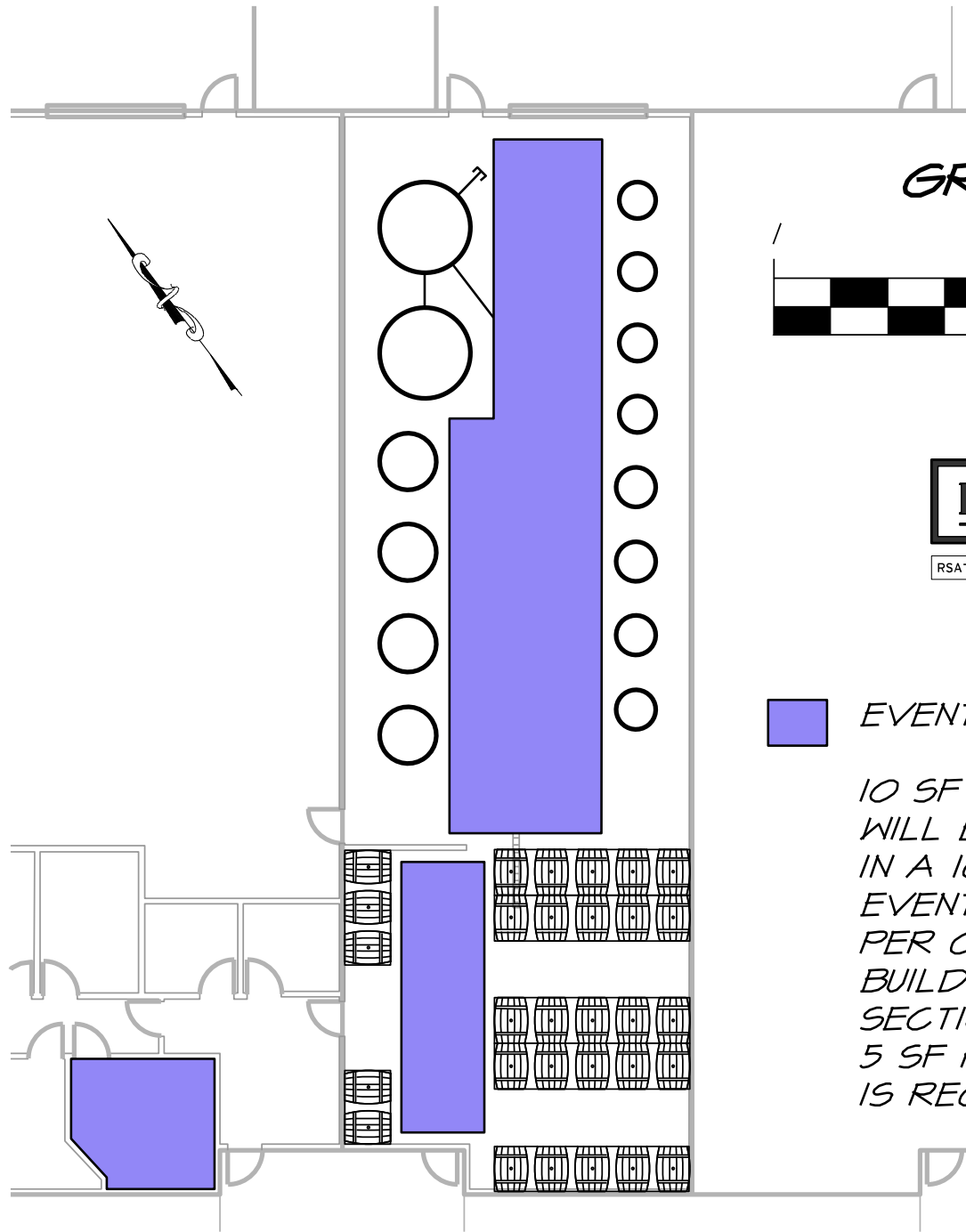

GRAPHIC SCALE



(IN FEET)

RSA+
1515 FOURTH ST
NAPA, CALIF. 9
OFFICE | 707 | 252.3301
+ www.RSAcivil.com +

RSA+ | CONSULTING CIVIL ENGINEERS + SURVEYORS + EST. 1980

 *EVENT AREA = 1024 SF*

*10 SF PER PERSON
WILL BE AVAILABLE
IN A 100 PERSON
EVENT
PER CALIFORNIA
BUILDING CODE
SECTION 1005
5 SF PER PERSON
IS REQUIRED*