



NAPA COUNTY

DEPARTMENT OF PUBLIC WORKS

1195 THIRD STREET • ROOM 201 • NAPA, CALIFORNIA 94559-3092
PHONE 707-253-4351 • FAX 707-253-4627
www.co.napa.ca.cu/PublicWorks

ROBERT J. PETERSON
Director of Public Works
County Surveyor-County Engineer
Road Commissioner

Date Received: _____

Permit #: _____

LOT LINE ADJUSTMENT APPLICATION

Road Name: _____

Applicant: _____ Applicant Phone #: _____

Owner: _____ APN: _____

Owner : _____ APN: _____

Owner: _____ APN: _____

Owner : _____ APN: _____

Title Company Name: _____ Title Officer: _____

Title Company Order #: _____

Surveyor: _____ Surveyor Contact: _____

The following items are required to process LLA applications:

1. Processing fee of \$2,022.00.
2. Copies of recorded Final Map, Parcel Map, Certificate of Compliance, Deed(s), that establish each parcel(s) as a legal parcel(s). (Section 17.02.320)
3. One copy of a Preliminary Title Report, issued within 30 days of submittal of the LLA application.
4. Three copies of Tentative Lot Line Adjustment Map accurately drawn to a scale of 8 ½" x 11" paper.
5. The signed consent of the owner of each parcel involved in the Lot Line Adjustment.
6. A Preliminary Title Report (Notification Package), which includes adhesive labels, containing a list of the names and addresses of property owners contiguous to the parcels involved in the Lot Line Adjustment.
7. Copies of the Williamson Act Contracts (Agricultural Contracts) affecting the existing parcels (if applicable).

LEGEND

- PROPERTY LINE - EXISTING
- PROPERTY LINE - PROPOSED
- PROPERTY LINE - FORMER
- GRAVEL ROAD
- PAVED ROAD

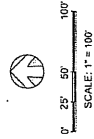
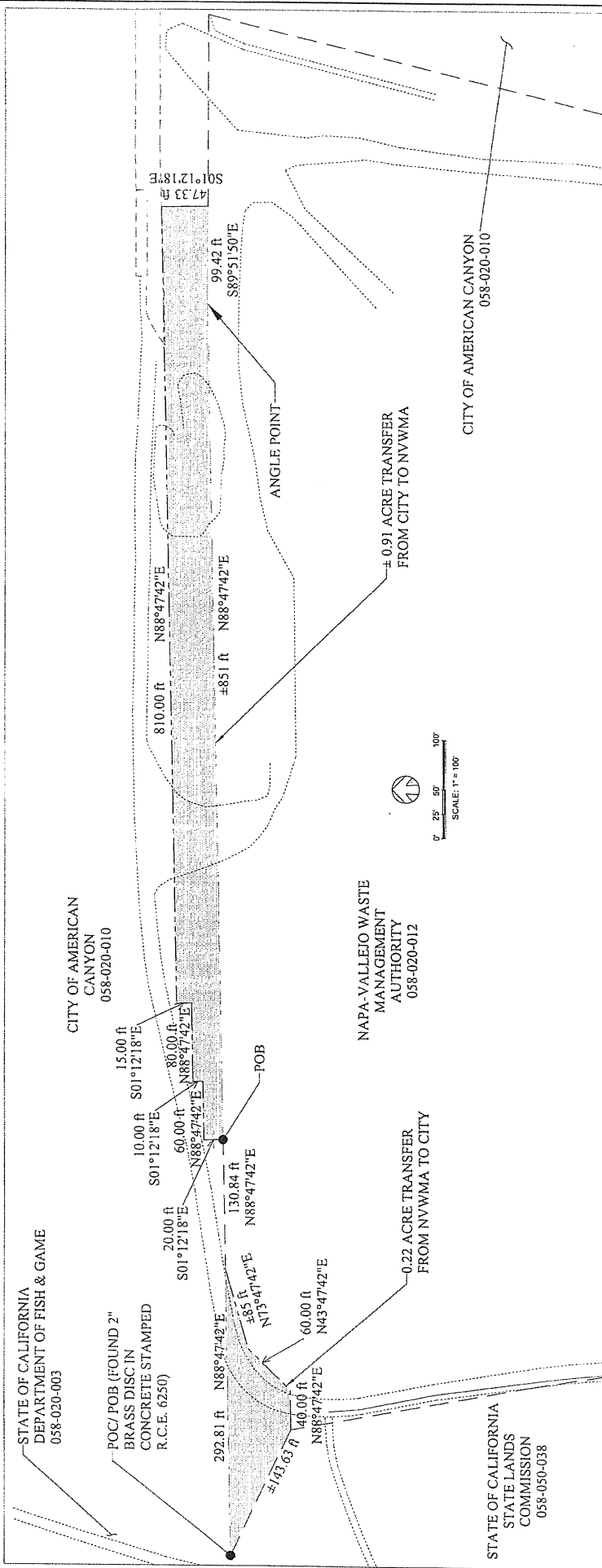

Case
B
EXHIBIT
B
Sheet 1 of 1

LOT LINE ADJUSTMENT EXHIBIT
LANDS TRANSFER BETWEEN
CITY OF AMERICAN CANYON AND
NAPA VALLEJO WASTE
MANAGEMENT AUTHORITY

Date: Jul 1, 2006
Owner: CHN
Checked: JP
Approved: CHN

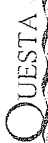

 Cal
 Environmental
 & Water Resources
 14500 Sycamore Ave.
 Suite 100
 P.O. Box 21306 1720 Skyway Drive, Head - Round Bay, Richmond, CA 94807