

# MOUNTAIN PEAK WINERY

## SODA CANYON ROAD STUDY

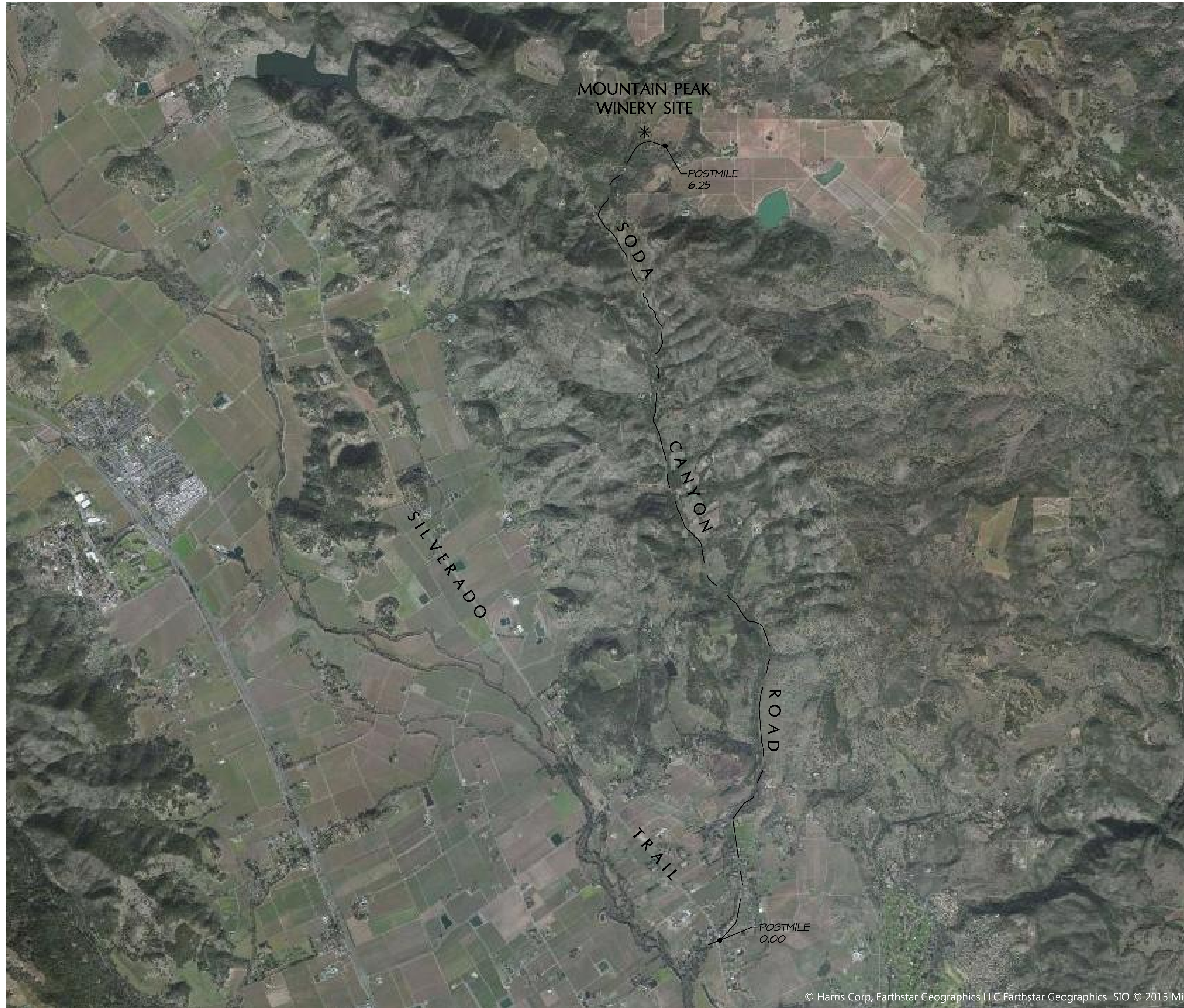

VICINITY MAP

SCALE: 1" = 2000'

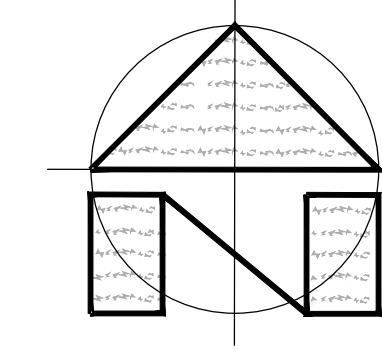

SCALE: 1" = 2000'

MOUNTAIN PEAK WINERY SITE

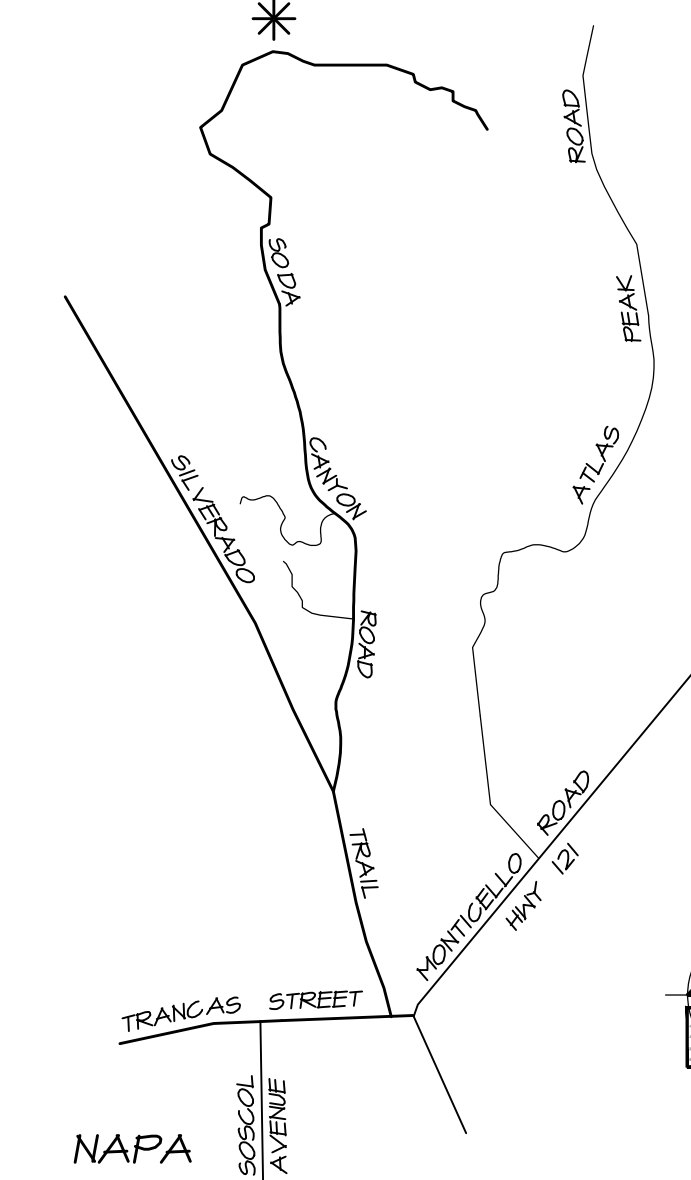

LOCATION MAP  
NO SCALE

**PROJECT INFORMATION:**

**PROPERTY OWNER:**  
MOUNTAIN PEAK VINEYARDS, LLC  
C/O HUA YUAN  
3265 SODA CANYON ROAD  
NAPA, CA 94558

**PROJECT APPLICANT:**  
MOUNTAIN PEAK VINEYARDS, LLC  
C/O STEVEN REA  
1114 PETRA DRIVE  
NAPA, CA 94558  
310-913-0742

**PROJECT ADDRESS:**  
3265 SODA CANYON ROAD  
NAPA, CA 94558

**ASSESSOR'S PARCEL NUMBER:**  
032-500-033

**SHEET INDEX:**

- SHEET 1 VICINITY MAP
- SHEET 2 SODA CANYON ROAD STUDY - ALIGNMENT & PROFILE (PM 0.00 TO PM 2.25)
- SHEET 3 SODA CANYON ROAD STUDY - ALIGNMENT & PROFILE (PM 2.25 TO PM 4.50)
- SHEET 4 SODA CANYON ROAD STUDY - ALIGNMENT & PROFILE (PM 4.50 TO PM 6.25)

5/12/2016 - 12:02 PM, S:\LAND PROJECTS\2017-2018\0831-MOUNTAIN PEAK VINEYARDS\0831-SODA CANYON\0831-P4P.DWG, P4P - VICINITY, ASCII, EXPAND D (8600 X 2400 INCHES), 1" = 1", PLOTTED & BARTELT ENGINEERING, 107-258-1301

OWNERSHIP OF DOCUMENTS  
THIS DOCUMENT IS THE PROPERTY OF BARTELT ENGINEERING AND IS NOT TO BE REPRODUCED, COPIED, OR TRANSMITTED IN ANY FORM OR BY ANY MEANS, ELECTRONIC OR MECHANICAL, INCLUDING PHOTOCOPYING, RECORDING, OR BY ANY INFORMATION STORAGE AND RETRIEVAL SYSTEM. ALL RIGHTS ARE RESERVED.  
DESIGN: MMV/MG  
DRAWN: MMV  
CHECKED: PNB  
DATE: MAY 2016  
FILE NO: 0831-P4P.DWG  
JOB NO: 08-31  
SHEET NO: 1  
OF 4

**BARTELT ENGINEERING**  
CIVIL ENGINEERING - LAND PLANNING  
1003 Jefferson Street, 200 B, Napa, CA 94559  
www.barttelengineering.com  
Telephone: 707-258-1301

MOUNTAIN PEAK WINERY  
VICINITY MAP  
COUNTY OF NAPA  
CALIFORNIA

DATE: MAY 2016  
FILE NO: 0831-P4P.DWG  
JOB NO: 08-31  
SHEET NO: 1  
OF 4



SILVERADO TRAIL

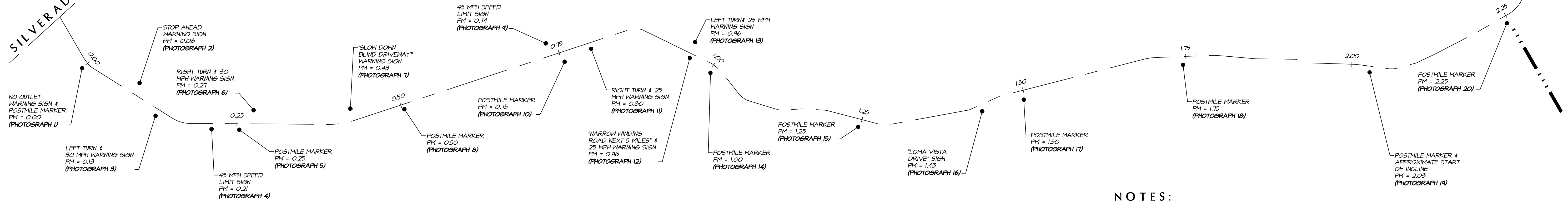

**SODA CANYON ROAD ALIGNMENT**  
PM 0.00 TO PM 2.25

SCALE: 1" = 400'

**NOTES:**

- ELEVATIONS WERE DEVELOPED FROM THE NAPA COUNTY GEOGRAPHIC INFORMATION SYSTEM MAPS OF THE NAPA RIVER WATERSHED.
- PHOTOGRAPHS SHOWN HEREON WERE TAKEN ON MARCH 10, 2015 BY A REPRESENTATIVE OF BARTELT ENGINEERING.

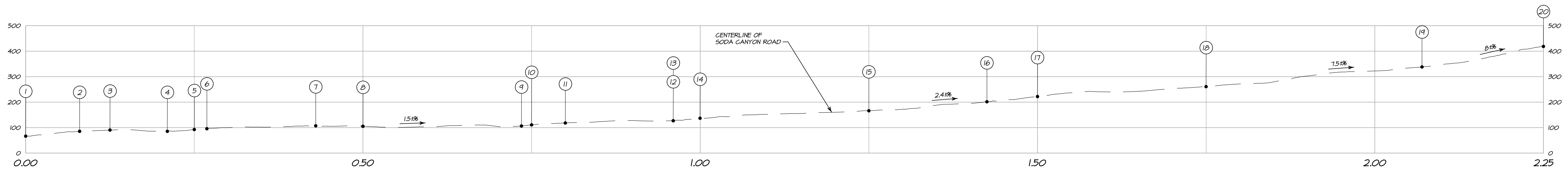

**SODA CANYON ROAD PROFILE**  
PM 0.00 TO PM 2.25

HORIZONTAL SCALE: 1" = 400'  
VERTICAL SCALE: 1" = 200'



PHOTOGRAPH 1  
NORTHBOUND



PHOTOGRAPH 2  
SOUTHBOUND



PHOTOGRAPH 3  
NORTHBOUND



PHOTOGRAPH 4  
NORTHBOUND



PHOTOGRAPH 5  
NORTHBOUND

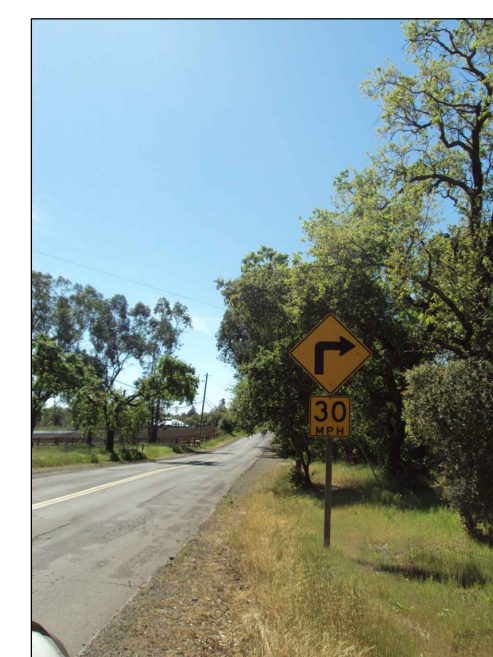

PHOTOGRAPH 6  
SOUTHBOUND



PHOTOGRAPH 7  
SOUTHBOUND



PHOTOGRAPH 8  
NORTHBOUND



PHOTOGRAPH 9  
SOUTHBOUND



PHOTOGRAPH 10  
NORTHBOUND



PHOTOGRAPH 11  
NORTHBOUND



PHOTOGRAPH 12  
NORTHBOUND



PHOTOGRAPH 13  
SOUTHBOUND

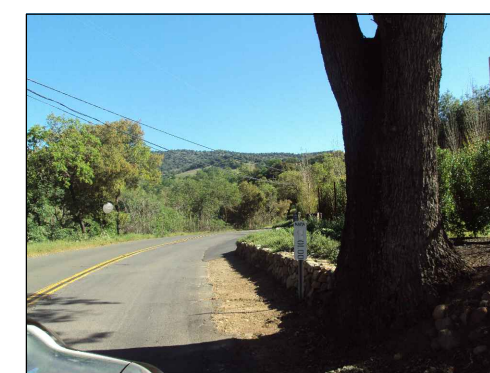

PHOTOGRAPH 14  
NORTHBOUND



PHOTOGRAPH 15  
NORTHBOUND

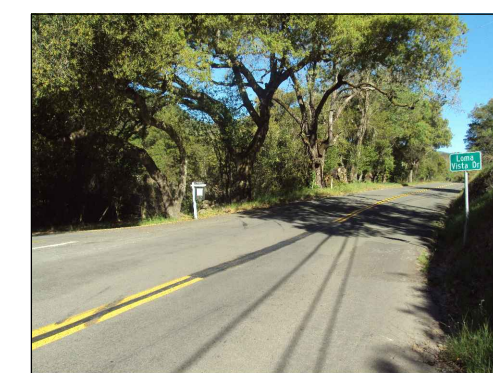

PHOTOGRAPH 16  
NORTHBOUND



PHOTOGRAPH 17  
NORTHBOUND



PHOTOGRAPH 18  
NORTHBOUND

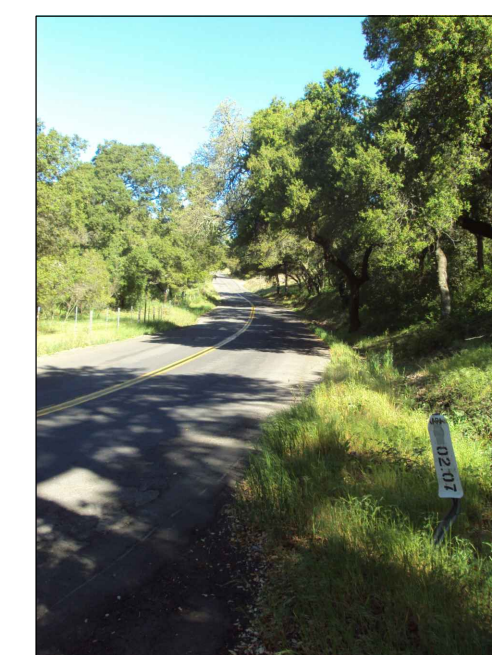

PHOTOGRAPH 19  
NORTHBOUND



PHOTOGRAPH 20  
NORTHBOUND

OWNERSHIP OF DOCUMENTS  
THIS DOCUMENT AND THE IDEAS INCORPORATED HEREIN AS AN INSTRUMENT OF PROFESSIONAL SERVICE IS THE PROPERTY OF BARTELT ENGINEERING AND IS NOT TO BE USED IN ANY OTHER PROJECT WITHOUT THE WRITTEN CONSENT OF BARTELT ENGINEERING. UNAUTHORIZED REPRODUCTION OR TRANSMISSION OF THIS DOCUMENT IS PROHIBITED. BARTELT ENGINEERING SHALL BE RESPONSIBLE FOR THE ACCURACY OF THE INFORMATION PROVIDED HEREIN. BARTELT ENGINEERING, CIVIL ENGINEERING - LAND PLANNING, 1303 JEFFERSON STREET, 200 B, NAPA, CA 94959. WWW.BARTELTEENGINEERING.COM. TELEPHONE: 707-258-1301. FAX: 707-258-1302. COPYRIGHT 2016. ALL RIGHTS RESERVED.

DES: NAA / MS	CHKD: PNB
DRWN: NAA	

**BARTELT ENGINEERING**  
CIVIL ENGINEERING - LAND PLANNING  
1303 JEFFERSON STREET, 200 B, NAPA, CA 94959  
WWW.BARTELTEENGINEERING.COM  
Telephone: 707-258-1301

MOUNTAIN PEAK WINERY  
**SODA CANYON ROAD STUDY**  
COUNTY OF NAPA  
CALIFORNIA

DATE: MAY 2016  
FILE NO: 0831-P4.PDWG  
JOB NO: 08-31  
SHEET NO:

5/12/2016 - 12:27 PM: kmg, 5: LAND PROJ: 0831-0007-20210301-ACAD/PLANS/WINERY/USE PERMIT/0831-SODA/CANYONRD\_P4.PDWG, ARCH EXPAND C (86.00 X 24.00 INCHES), 1" = 1', PLOTTED @ BARTELT ENGINEERING, 707-258-1301



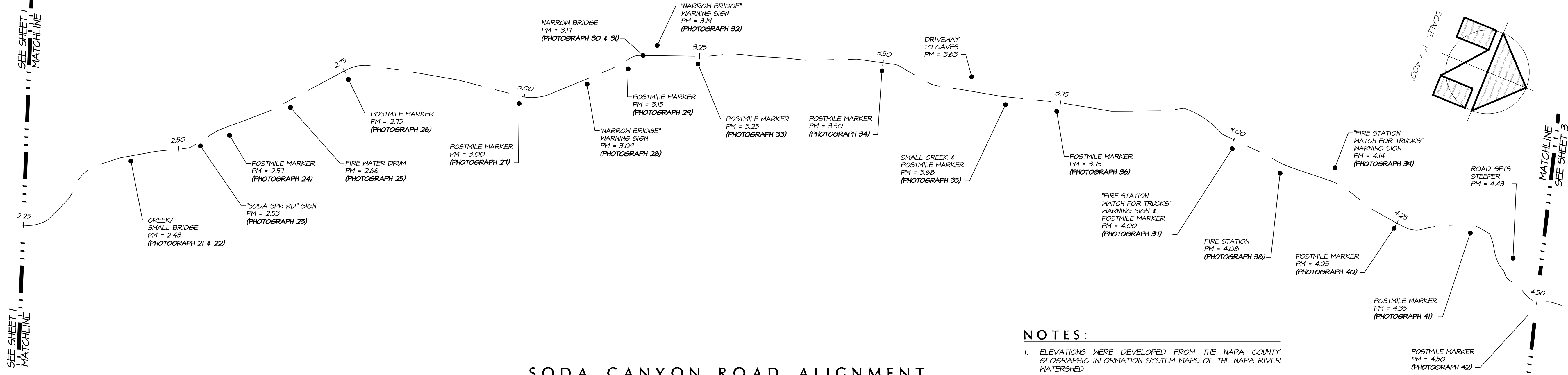

**SODA CANYON ROAD ALIGNMENT**  
PM 2.25 TO PM 4.50

SCALE: 1" = 400'

- NOTES:**
- ELEVATIONS WERE DEVELOPED FROM THE NAPA COUNTY GEOGRAPHIC INFORMATION SYSTEM MAPS OF THE NAPA RIVER WATERSHED.
  - PHOTOGRAPHS SHOWN HEREON WERE TAKEN ON MARCH 10, 2015 BY A REPRESENTATIVE OF BARTELT ENGINEERING.

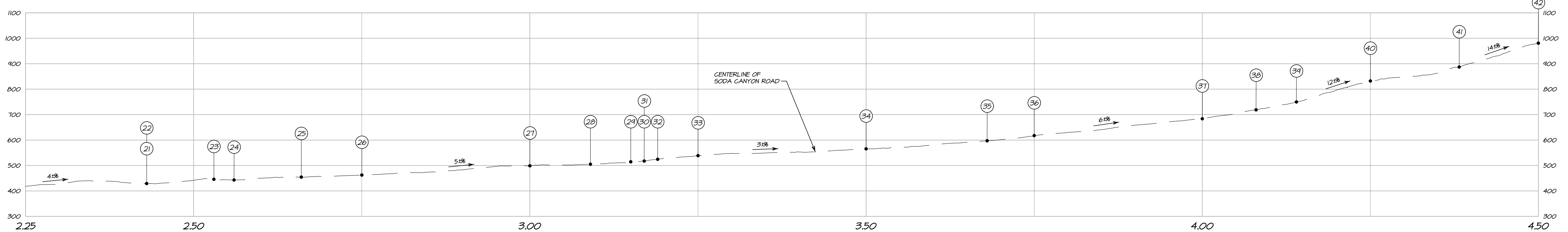

**SODA CANYON ROAD PROFILE**  
PM 2.25 TO PM 4.50

HORIZONTAL SCALE: 1" = 400'  
VERTICAL SCALE: 1" = 200'



OWNERSHIP OF DOCUMENTS  
THIS DOCUMENT AND THE IDEAS INCORPORATED HEREIN ARE THE PROPERTY OF BARTELT ENGINEERING. NO PART OF THIS DOCUMENT IS TO BE REPRODUCED OR TRANSMITTED IN ANY FORM OR BY ANY MEANS, ELECTRONIC OR MECHANICAL, INCLUDING PHOTOCOPYING, RECORDING, OR BY ANY INFORMATION STORAGE AND RETRIEVAL SYSTEM, WITHOUT THE WRITTEN PERMISSION OF BARTELT ENGINEERING. ANY CHANGES TO THE PLANS MUST BE IN WRITING AND MUST BE APPROVED BY THE ENGINEER. THE CLIENT OF BARTELT ENGINEERING AND ANY CONTRACTORS AND SUBCONTRACTORS SHALL BE RESPONSIBLE TO VERIFY THAT THIS DRAWING REPRESENTS THE LATEST INFORMATION RELATIVE TO THE PROJECT.  
© COPYRIGHT 2016. ALL RIGHTS RESERVED.

DES: MM / MS	DRAW: MM	CHECK: PMB
--------------	----------	------------

**BARTELT ENGINEERING**  
CIVIL ENGINEERING - LAND PLANNING  
1303 Jefferson Street, 200 B, Napa, CA 94959  
www.barteltengineering.com  
Telephone: 707-258-1301

MOUNTAIN PEAK WINERY  
**SODA CANYON ROAD STUDY**  
CALIFORNIA  
COUNTY OF NAPA

DATE: MAY 2016
FILE NO: 0831-P4P.DWG
JOB NO: 08-31
SHEET NO:

9/2/2016 - 12:28 PM - 4x11x8.5 - LAND PROJECTS/2016/0831/AGADP/ANIMATED/USE RESOURCES/SODA\_CANYON\_ROAD\_P4P.DWG - PLOTTED & BARTELT ENGINEERING 707-258-1301



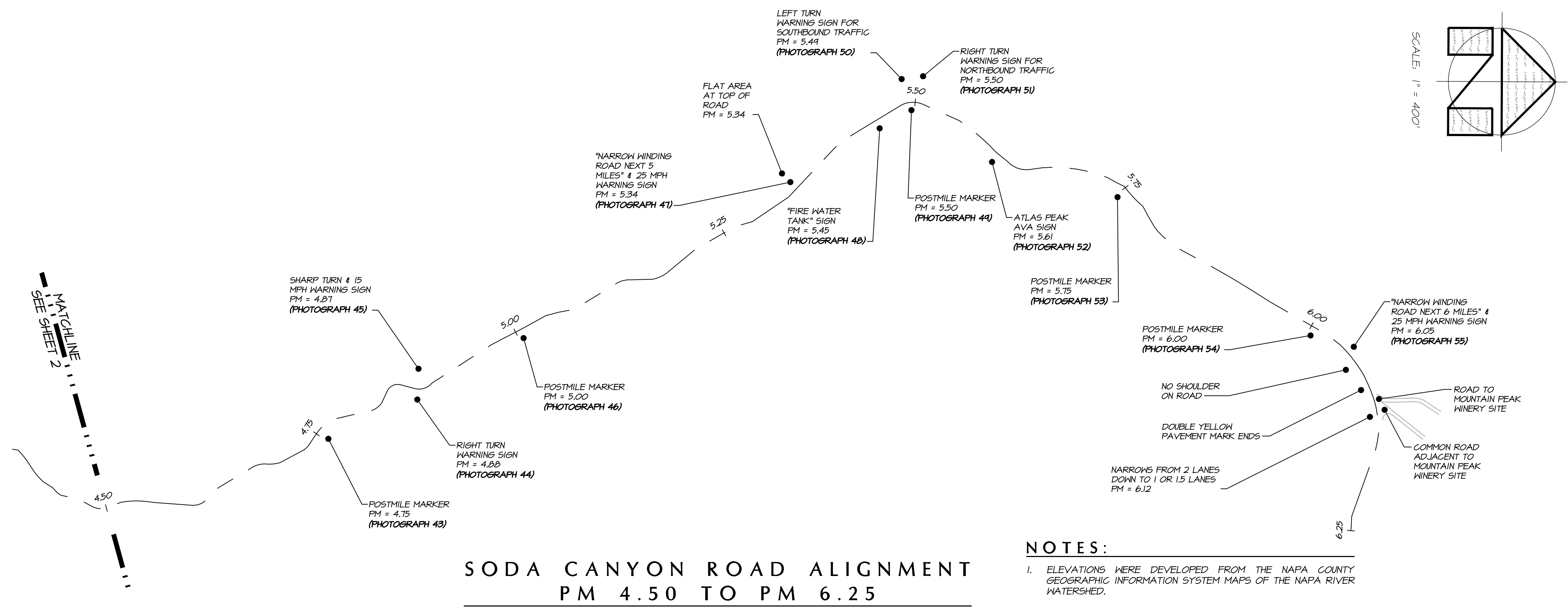

**SODA CANYON ROAD ALIGNMENT**  
PM 4.50 TO PM 6.25

SCALE: 1" = 400'

- NOTES:**
- ELEVATIONS WERE DEVELOPED FROM THE NAPA COUNTY GEOGRAPHIC INFORMATION SYSTEM MAPS OF THE NAPA RIVER WATERSHED.
  - PHOTOGRAPHS SHOWN HEREON WERE TAKEN ON MARCH 18, 2015 BY A REPRESENTATIVE OF BARTELT ENGINEERING.

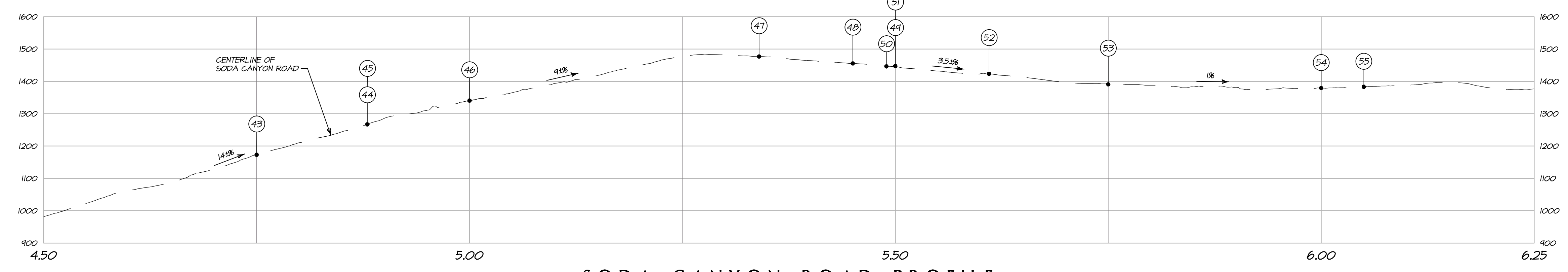

**SODA CANYON ROAD PROFILE**  
PM 4.50 TO PM 6.25

HORIZONTAL SCALE: 1" = 400'  
VERTICAL SCALE: 1" = 200'



**PHOTOGRAPH 43**  
NORTHBOUND



**PHOTOGRAPH 44**  
NORTHBOUND



**PHOTOGRAPH 45**  
SOUTHBOUND



**PHOTOGRAPH 46**  
NORTHBOUND



**PHOTOGRAPH 47**  
SOUTHBOUND

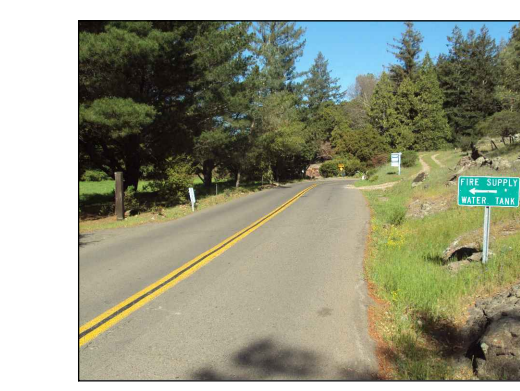

**PHOTOGRAPH 48**  
NORTHBOUND



**PHOTOGRAPH 49**  
NORTHBOUND



**PHOTOGRAPH 50**  
SOUTHBOUND



**PHOTOGRAPH 51**  
NORTHBOUND



**PHOTOGRAPH 52**  
NORTHBOUND



**PHOTOGRAPH 53**  
NORTHBOUND



**PHOTOGRAPH 54**  
NORTHBOUND



**PHOTOGRAPH 55**  
SOUTHBOUND

5/12/2016 - 12:31 PM 1419g. 5 LAND PROJECT/2007-2021/03/31/ACAD/PLANS/WINERY/USE PERMIT/031-SODA CANYON RD - P1.P1.DWG P1-P1-25) ARZM EXPAND D (26,000 X 24,000 INCHES) 1" = 1', PLOTTED @ BARTELT ENGINEERING, 707-258-1301

CONSENT OF DOCUMENTS  
THIS DOCUMENT AND THE IDEAS INCORPORATED HEREIN AS AN INSTRUMENT OF PROFESSIONAL SERVICE IS THE PROPERTY OF BARTELT ENGINEERING AND IS NOT TO BE USED IN WHOLE OR IN PART FOR ANY OTHER PROJECT WITHOUT THE WRITTEN CONSENT OF BARTELT ENGINEERING. BARTELT ENGINEERING SHALL NOT BE RESPONSIBLE FOR OR LIABLE FOR UNAUTHORIZED CHANGES TO THIS DOCUMENT. ANY CHANGES TO THIS DOCUMENT MUST BE MADE IN WRITING AND APPROVED BY BARTELT ENGINEERING. COPIES MADE FROM THIS DRAWING ARE FOR THE USE OF SUBMITTALS ONLY. IT IS THE RESPONSIBILITY OF THE USER TO VERIFY THAT THIS DRAWING REPRESENTS THE LATEST INFORMATION. © COPYRIGHT 2016. ALL RIGHTS RESERVED.

DES: NAA / NS	DRWN: NAA	CHKD: FNB
---------------	-----------	-----------

**BARTELT ENGINEERING**  
CIVIL ENGINEERING - LAND PLANNING  
1303 Jefferson Street, 200 B, Napa, CA 94959  
www.barteltengineering.com  
Telephone: 707-258-1301

PROJECT: MOUNTAIN PEAK WINERY SODA CANYON ROAD STUDY  
DATE: MAY 2016  
FILE NO: 0831-P1.P1.DWG  
JOB NO: 08-31  
SHEET NO: 4 OF 4

MOUNTAIN PEAK WINERY  
SODA CANYON ROAD STUDY  
COUNTY OF NAPA  
CALIFORNIA

DATE: MAY 2016  
FILE NO: 0831-P1.P1.DWG  
JOB NO: 08-31  
SHEET NO: 4 OF 4